

Mayfield Park South

FISHPONDS

APPROXIMATE FLOOR AREA
94.7 SQM / 1019 SQFT



GROUND FLOOR
641 sq.ft. (59.5 sq.m.) approx.

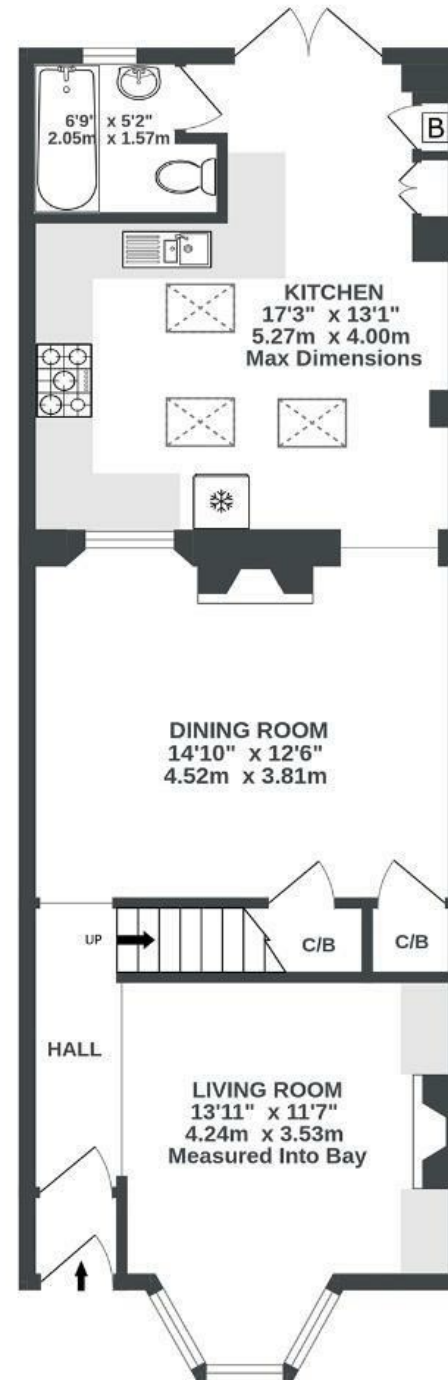

1ST FLOOR
378 sq.ft. (35.2 sq.m.) approx.

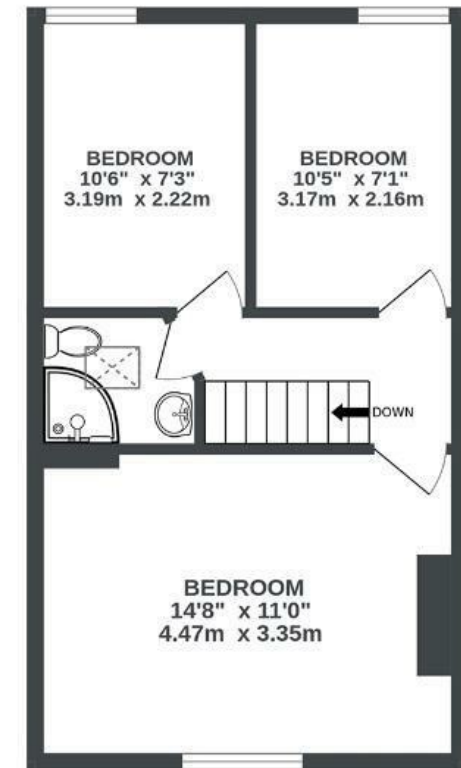

Illustrations are for reference purposes only, measurements are approximate, not to scale.

Boardwalk

Mayfield Park

FISHPONDS, BRISTOL



£395,000



3 Bedrooms



BS16 3NF



2 Bathrooms

"We have loved living in this home and starting our family here. Mayfield Park South is a wonderful place to live with great neighbours. The house has so much charm. The south facing garden is a real sun trap and a beautiful green space come spring. We have rear access leading into Coombe Brook Nature Reserve and lots of open spaces."

